



1775 E US 20,
LaGrange, IN 46761

BY RIVERSIDE RV

www.riversidervs.net

Your lite-weight travel trailer headquarters.



180R



- SPECIFICATIONS -

| Model | 509 | 157 | 166 | 177FK | 177SE | 179 | 180 | 189 | 190 | 195 | 199FKS | 265RB | 285FK | 290 |
|-------------------------|-----------|-----------|-----------|-----------|-----------|-----------|-----------|-----------|-----------|-----------|-----------|------------|------------|------------|
| Overall Length | 13'8" | 15'6" | 16'4" | 18'9" | 18'9" | 20'3" | 20'8" | 23'8" | TBA | 24'11" | 25'10" | 27'10" | 31' | 32'3" |
| Average Shipping Weight | 1,180 | 2,520 | 2,500 | 3,100 | 3,060 | 3,240 | 3,575 | 3,750 | TBA | 3,925 | 4,395 | 4,795 | 5,675 | 6,100 |
| Hitch Weight | 200 | 200 | 260 | 480 | 420 | TBA | 340 | 360 | TBA | 580 | 840 | 500 | 920 | 660 |
| Carrying Capacity | 500 | 1,000 | 1,190 | 1,380 | 820 | TBA | 3,760 | 3,610 | TBA | 3,795 | 3,420 | 2,680 | 2,245 | 1,800 |
| Exterior Width | 5' | 7'6" | 6'10" | 8' | 8' | 8' | 8' | 8' | 8' | 8' | 8' | 8' | 8' | 8' |
| Exterior Height of Unit | 7' | 9'6" | 8'10" | 9'2" | 9'2" | 9'2" | 10'1" | 9'10" | 10'4" | 9'8" | 9'10" | 10'4" | 10'8" | 10'8" |
| Ceiling Height of Unit | 4'5" | 6'4" | 6' | 6'5" | 6'5" | 6'5" | 6'8" | 6'8" | 6'6" | 6'5" | 6'5" | 6'6" | 6'6" | 6'6" |
| Number of Axles | 1 | 1 | 1 | 1 | 1 | 1 | 2 | 2 | 1 | 2 | 2 | 2 | 2 | 2 |
| Axle Weight Rating | 1,500# | 3,500# | 3,500# | 4,000# | 4,000# | 4,000# | 3,500# | 3500# | 4,000# | 3,500# | 3500# | 3500# | 3500# | 3500# |
| Tire Size | 13" | 14" | 14" | 15" | 15" | 15" | 14" | 14" | 15" | 14" | 14" | 14" | 14" | 14" |
| Awning Size | N/A | 6' | 6' | 14' | 9' | 11' | 10' | 12' | TBA | 12' | 12' | 12' | 16' | 14' |
| Furnace BTU | N/A | 16,000BTU | 16,000BTU | 20,000BTU | 20,000BTU | 20,000BTU | 20,000BTU | 20,000BTU | 20,000BTU | 20,000BTU | 20,000BTU | 30,000BTU | 30,000BTU* | 30,000BTU* |
| A/C BTU | 10,000BTU | 10,000BTU | 10,000BTU | 10,000BTU | 10,000BTU | 10,000BTU | 13,500BTU | 13,500BTU | 13,500BTU | 13,500BTU | 13,500BTU | 15,000BTU* | 15,000BTU* | 15,000BTU* |
| Fresh Water (gal.) | 17 | 11 | 11 | 39 | 39 | 39 | 39 | 39 | 39 | 39 | 39 | 39 | 39 | 39 |
| Grey Water (gal.) | N/A | 17 | 18 | 32 | 32 | 32 | 32 | 32 | 32 | 32 | 49 | 32 | 64 | 64 |
| Black Water (gal.) | N/A | 12 | 5 | 17 | 12 | 17 | 17 | 17 | 17 | 17 | 17 | 17 | 17 | 17 |

Riverside reserves the right to make changes and corrections as needed.

*Ducted

**Thank you for your interest
in Riverside RV.**

We offer a complete line of lite-weight,
lite-priced travel trailers. You are invited to
visit our website for additional information.

Dealer:

Kerola Campers Inc.
3610 N. Hermitage Rd.
Transfer, PA 16154
724-962-4561 www.kerola.com

FLOORPLANS

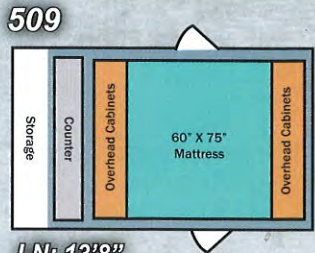

LN: 13'8"

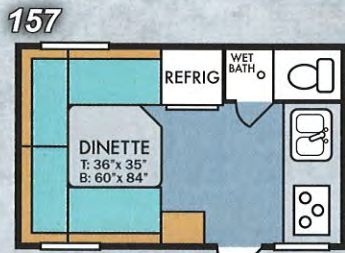

LN: 15'6"

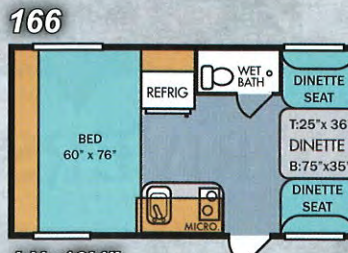

LN: 16'4"

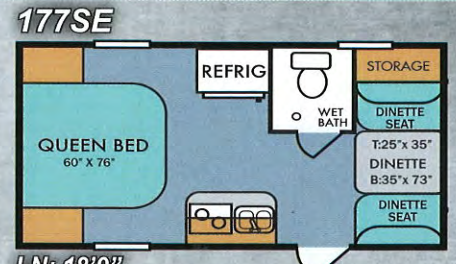

LN: 18'9"

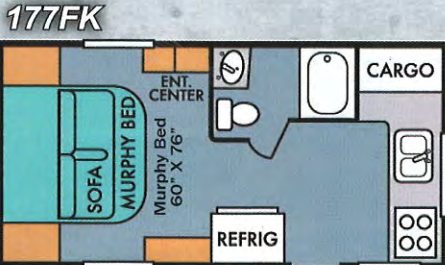

LN: 18'9"

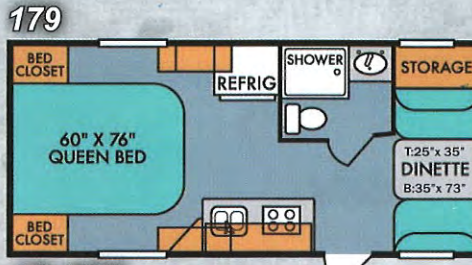

LN: 20'3"

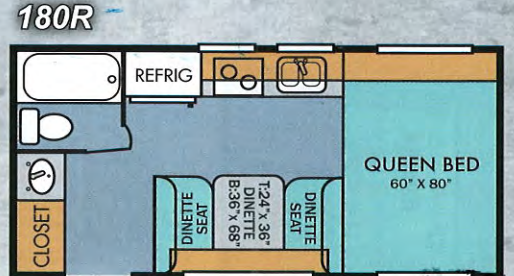

LN: 20'8"

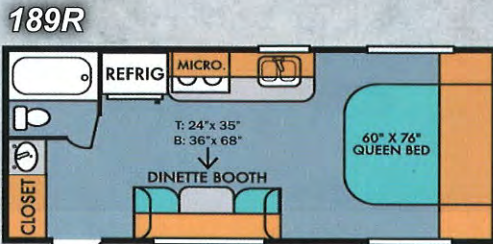

LN: 23'8"

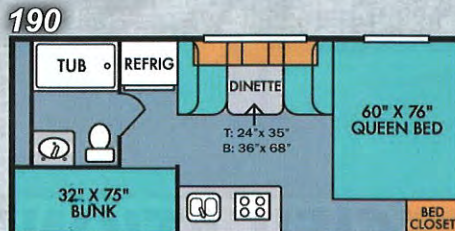

LN: TBA

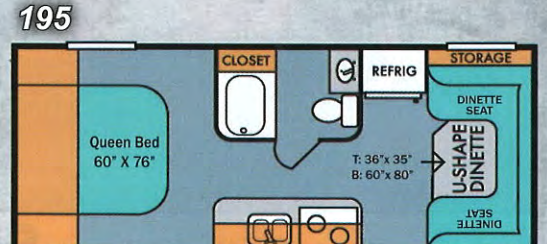

LN: 24'11"

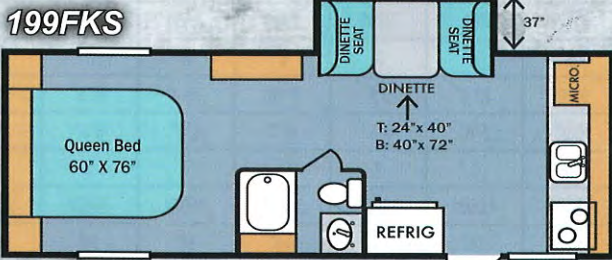

LN: 25'10"

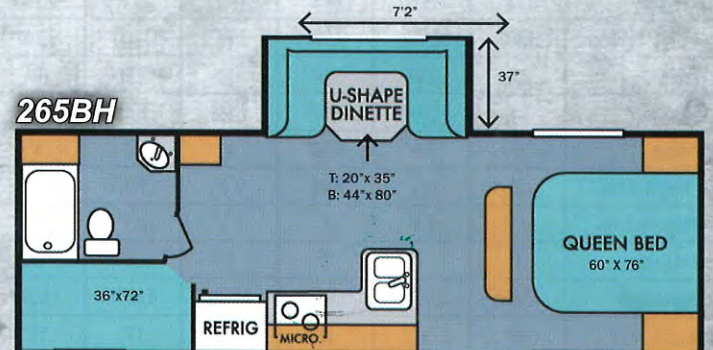

LN: 27'10"

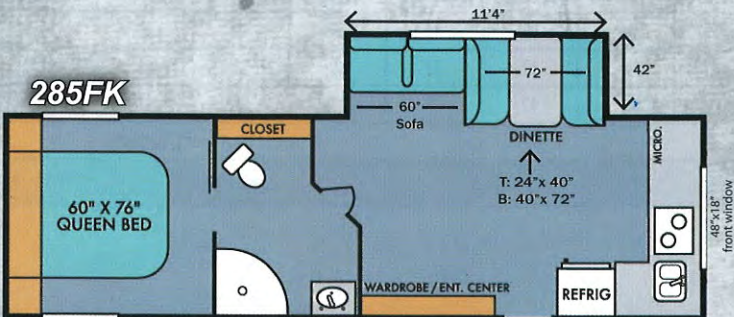

LN: 31'

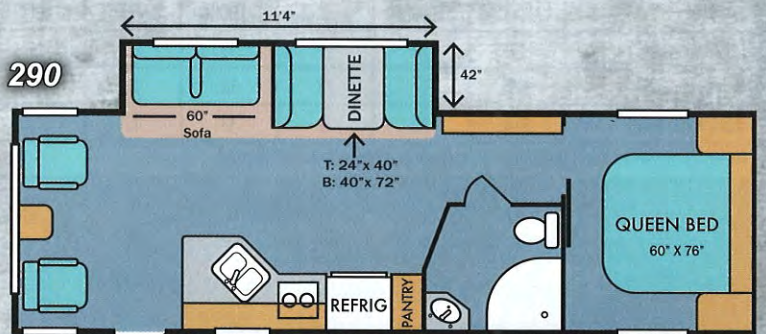

LN: 32'3"

T= Table B= Bed